

Assembly and removal Instructions for MTGSystems Ripmet®

Assembly instructions

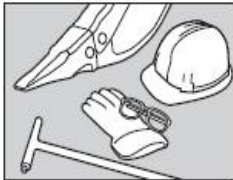

Recommended equipment

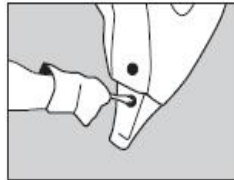

Clean the adapter and push in both retainers

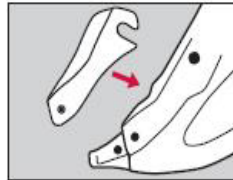

Place the protector

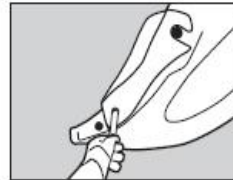

Push in the pin

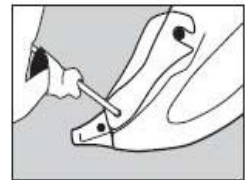

Turn the pin clockwise

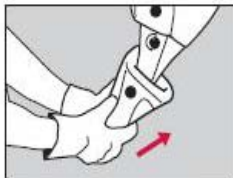

Assemble the tooth

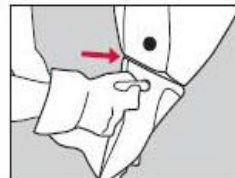

Push in the pin



Turn the pin clockwise

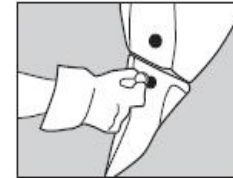

Attach the plug

Removal instructions

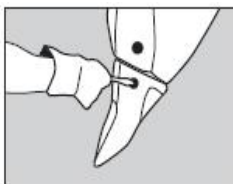

Remove the plug

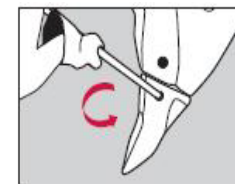

Turn the pin counterclockwise



Remove the pin