

## Assembly and removal Instructions for MTGSystems ProMet®

### Assembly Instructions

### Lateral Protectors

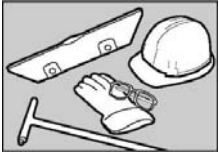

An extracting tool is required for fitting and removing MTG Systems ProMet protectors. The use of protective clothing is recommended: hard hat, gloves and goggles.

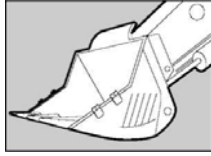

To facilitate fitting and removal of the protectors, it is recommended that the bucket be positioned with the teeth tilted slightly upwards.

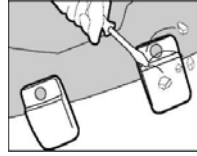

Clean the bases of the side protector and the housings of the retainers thoroughly to allow the new protector to be fitted.

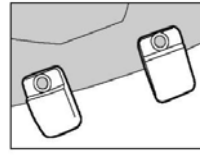

Place the retainers in the holes, as shown in the diagram.

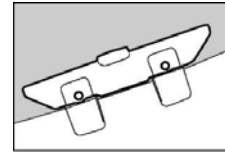

Fit the protector

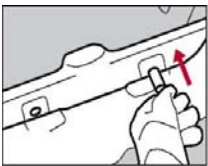

Insert the pin manually until can go no further.

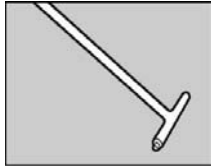

This is a standard-sized, square-head tool.

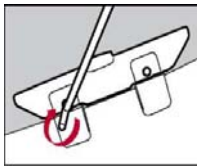

Place the square head of the extracting tool into the pin cavity and turn the pin clockwise.

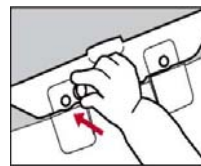

Fit a plug to prevent the square cavity of the pin becoming filled with dirt. This saves cleaning time when removing the pin.

### Removal Instructions

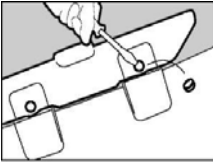

Remove the plug so that the pin can be taken out using the extracting tool.

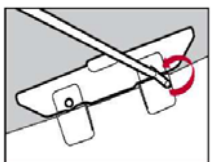

Place the square head of the extracting tool into the pin cavity and turn the pin anti-clockwise.

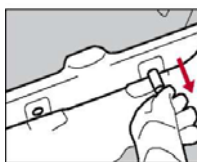

Manually remove the pins, releasing the protector. Remove the protector.

### Assembly Instructions

### Blade Protectors

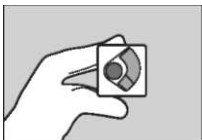

Place the retainer in the block.

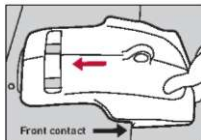

Place the shroud on the blade (with the two bases), contacting the front of the blade.

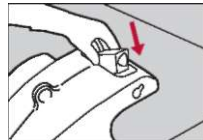

Place the block.

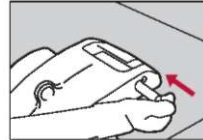

Insert the pin.



Turn the pin clockwise.



Place the plug in the pin.

### Removal Instructions

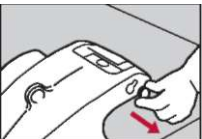

Remove the plug.

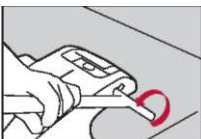

Turn the pin counter clockwise.

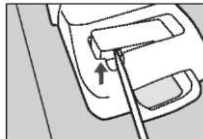

Remove the block, with the help of a screwdriver.

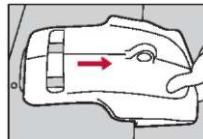

Replace the shroud for a new one.