

General instructions for assembly and disassembly of MTG Systems KingMet® teeth

Assembly instructions

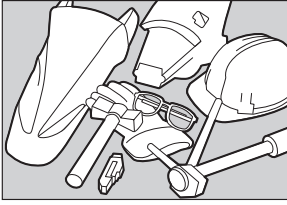

Equipment. For the assembly and disassembly of the MTG Systems KingMet teeth, you need a hammer and a removal tool. The use of protective clothing is recommended: helmet, glasses, gloves, and metal-toed boots.

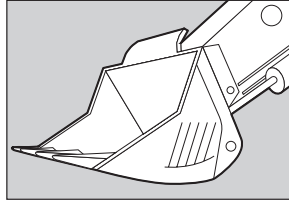

Position the bucket. In order to facilitate the assembly and disassembly of the teeth, it is recommended to place the bucket so that the teeth are facing slightly upwards.

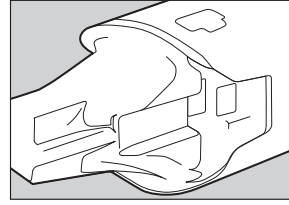

Clean. Clean the guide of the nose of the adapter and the pin housing, to allow the later assembly of the tooth and the pin.

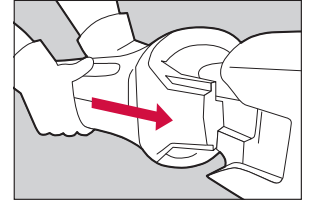

Assemble the tooth. Assemble the tooth on the nose of the adapter, fitting the retainer of the ear of the tooth into the lateral guide of the nose of the adapter.

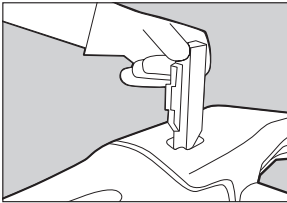

Place the pin. Put the pin in the housing of the adapters in the direction of the arrow on the body of the pin, so that the retainer is facing the tip of the tooth.

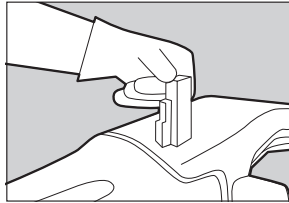

Position the pin. Manually make sure that the placement and position of the pin are correct.

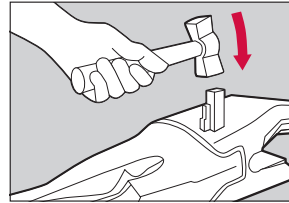

Pre-insert the pin. Hit the free end of the pin with the hammer until it is level with the body of the adapter.

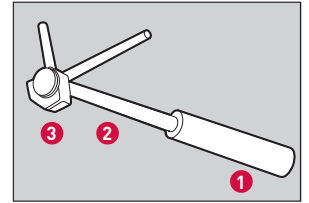

Removal tool. It is made up of a handle (1), a tube (2), and a head (3). On the head there are two appendages, a short one and a long one, and a pounding surface for each one of the appendages.

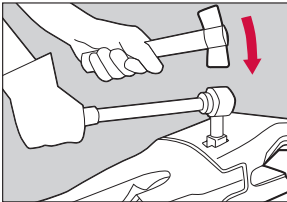

Insert the pin. Place the short appendage of the extractor on the end of the pin and hit it with the hammer until the pin is perfectly fixed in its housing.

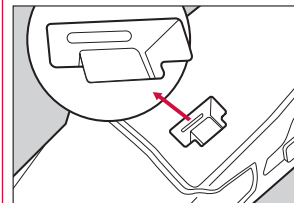

Correct position. The pin is correctly assembled when the mark inside the housing in the body of the adapter is completely visible.

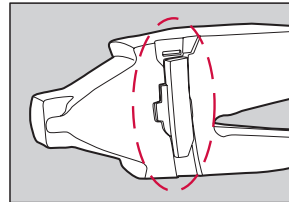

Correct position. Pin located within adapter so that the retainer faces the tip of the tooth.

Disassembly instructions

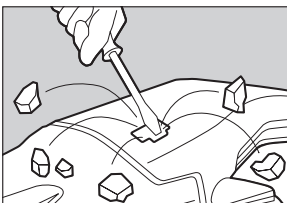

Clean. Although it is not indispensable, slightly clean the upper part of the hole of the adapter in order to allow the extractor to be better positioned.

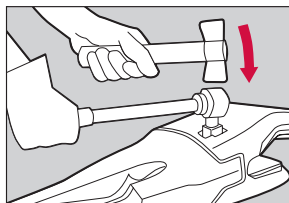

Position the extractor. Place the short appendage of the extractor in the upper part of the hole of the adapter.

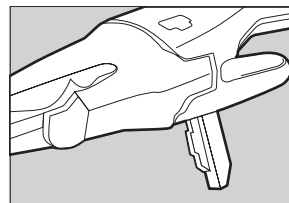

Extraction. Hit with the hammer until the retainer of the pin is free from its housing in the body of the adapter. Using the long appendage of the extractor, hit the pin until the pin comes out of the lower side of the adapter.